

7F SERIES Filter Fans and Exhaust Filters



Design by MINELLI | FOSSATI

Filter Fans from size 1 to size 5

To ensure the performance of components and instrumentation within control panels and enclosures.

- Operating voltage: 120 V AC, 230 V AC or 24 V DC (according to type)
- Easily replaceable filter mat
- Minimal depth within enclosure
- Air volume (24...700)m³/h
- Time-saving installation and maintenance
- Very low acoustic noise
- Protection category: IP54/Type 12
- Black colour RAL 9004 available
- Dimensions from 120 mm up to 320 mm

Approvals (according to type)



Available versions

Standard Filter Fan	Operating voltage (V AC)	Operating voltage (V DC)	Air volume (m ³ /h)	Rated power (W) 50/60 Hz	Size	Standard Exhaust Filter	Reverse flow versions	Filter mat
7F.20.8.120.1020	120 V AC	—	24	27/21	1 (120 x 120 mm)	7F.02.0.000.1000	7F.21.8.120.1020	07F.15
7F.20.8.230.1020	230 V AC	—	24	23/18	1 (120 x 120 mm)	7F.02.0.000.1000	7F.21.8.230.1020	07F.15
7F.20.9.024.1020	—	24 V DC	24	3.6	1 (120 x 120 mm)	7F.02.0.000.1000	7F.21.9.024.1020	07F.15
7F.20.8.120.2055	120 V AC	—	55	30/25	2 (155 x 155 mm)	7F.02.0.000.2000	7F.21.8.120.2055	07F.25
7F.20.8.230.2055	230 V AC	—	55	29/25	2 (155 x 155 mm)	7F.02.0.000.2000	7F.21.8.230.2055	07F.25
7F.20.9.024.2055	—	24 V DC	55	7	2 (155 x 155 mm)	7F.02.0.000.2000	7F.21.9.024.2055	07F.25
7F.20.8.120.3100	120 V AC	—	100	30/25	3 (209 x 209 mm)	7F.02.0.000.3000	7F.21.8.120.3100	07F.35
7F.20.8.230.3100	230 V AC	—	100	29/25	3 (209 x 209 mm)	7F.02.0.000.3000	7F.21.8.230.3100	07F.35
7F.20.9.024.3100	—	24 V DC	100	7	3 (209 x 209 mm)	7F.02.0.000.3000	7F.21.9.024.3100	07F.35
7F.20.8.120.4250	120 V AC	—	250	42/48	4 (255 x 255 mm)	7F.02.0.000.4000	7F.21.8.120.4250	07F.45
7F.20.8.230.4250	230 V AC	—	250	46/50	4 (255 x 255 mm)	7F.02.0.000.4000	7F.21.8.230.4250	07F.45
7F.20.9.024.4250	—	24 V DC	250	43	4 (255 x 255 mm)	7F.02.0.000.4000	7F.21.9.024.4250	07F.45
7F.20.8.120.4400	120 V AC	—	400	72/120	4 (255 x 255 mm)	7F.02.0.000.4000	7F.21.8.120.4400	07F.46
7F.20.8.230.4400	230 V AC	—	400	69/112	4 (255 x 255 mm)	7F.02.0.000.4000	7F.21.8.230.4400	07F.46
7F.20.8.120.5550	120 V AC	—	550	75/102	5 (320 x 320 mm)	7F.02.0.000.5000	7F.21.8.120.5550	07F.56
7F.20.8.230.5550	230 V AC	—	550	76/116	5 (320 x 320 mm)	7F.02.0.000.5000	7F.21.8.230.5550	07F.56
7F.20.8.120.5700	120 V AC	—	700	110/140	5 (320 x 320 mm)	7F.02.0.000.5000	7F.20.8.120.5700	07F.55
7F.20.8.230.5700	230 V AC	—	700	106/120	5 (320 x 320 mm)	7F.02.0.000.5000	7F.20.8.230.5700	07F.55

Type 7F.2x.x.xxx.1020
Type 7F.2x.x.xxx.1020
Type 7F.2x.x.xxx.2055
Type 7F.2x.x.xxx.3100



Type 7F.2x.x.xxx.4250
Type 7F.2x.x.xxx.4400



Type 7F.2x.8.xxx.5550
Type 7F.2x.8.xxx.5700



Replacement of Filter mat

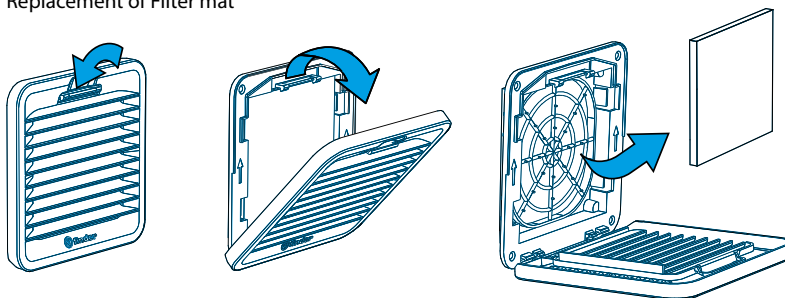

Mounting arrangement of Filter Fan and Exhaust Filter

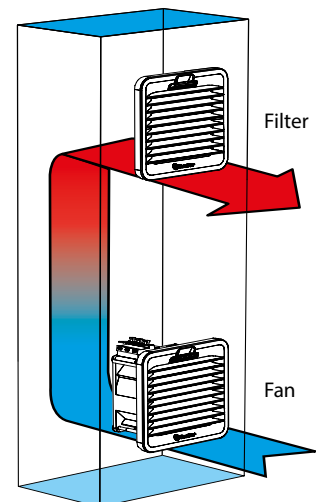

FINDER reserves the right to alter characteristics at any time without notice. FINDER assumes no liability for damage to persons or property, caused as a result of the incorrect use or application of its products.